

Remote Control & Motion-Sensor Spotlight – Item PMB371

INSTRUCTION GUIDE

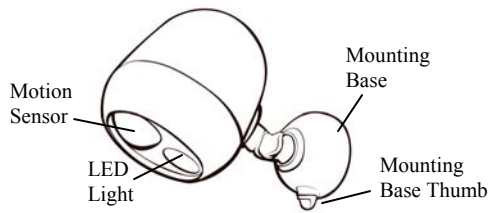

SPOTLIGHT

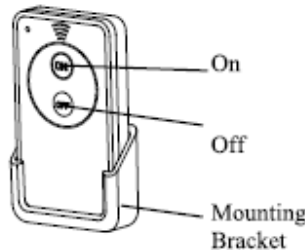

REMOTE



STAKE

Thank you for purchasing the Mr. Beams™ Remote Control and Motion Sensor Spotlight. We are committed to eliminating darkness by using the latest in light-emitting diodes (LED's). LED's are the most efficient and durable light sources available. We are certain that your Mr. Beams Spotlight will contribute to a safer environment and provide light where you need it at a very reasonable cost.

ENCLOSED YOU WILL FIND:

- Remote-Controlled and Motion-Sensor Spotlight with Mounting Base
- Remote Control with Mounting Bracket
- Stake
- 3 Screws and 2 Anchors

PMB371 SPOTLIGHT FEATURES

Remote Control—Turn Spotlight On and Off from Anywhere

Motion Sensor Activated – You can set the on-time of the light at 30 seconds or 10 minutes. Light shuts off automatically if no motion is detected.

Light Sensor – Motion-Sensor Spotlight goes on only in darkness to conserve battery life.

2 Brightness Settings – Choose “High” for maximum light, and “Low” for maximum battery life.

Mount to Wall or Use Stake – Motion-Sensor Spotlight can be rotated 360° as well as up and down.

WARNING

- Use only new alkaline or lithium D-Cell batteries with 1.5V rating. Do not mix old and new batteries. Install batteries with polarity in correct position.
- Follow battery instructions for proper disposal and cautions.
- Mount fixture securely with included screws, and use anchors if not securing to solid wood or other solid material. **Use the third screw if mounting Spotlight upside down!**

INSTALLATION INSTRUCTIONS

BEFORE YOU MOUNT YOUR SPOTLIGHT

Illustration 1a



Illustration 1b



Illustration 3a



Illustration 3b



Illustration 4

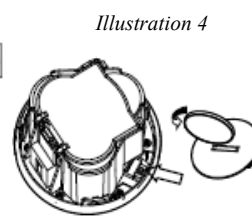

Illustration 5



1. Remove front cover of Spotlight by rotating counter-clockwise as shown in **Illustration 1a** to reveal controls and battery holders. Insert 3 D-Cell Batteries into Spotlight as shown in **Illustration 2**. Flat side of batteries match springs.

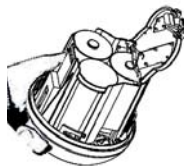

Illustration 2

2. Set your automatic shut-off time to Min or Max (**Illustration 3a**). NOTE: Light will stay on as long as motion is detected. **We recommend Min to save battery life.**

Min	Max
30 sec.	10 min.

3. Set your brightness to “Low” or “High” (**Illustration 3b**). Note: High will provide the equivalent light of a 25W incandescent bulb.

4. Match the code on your Spotlight with the code on your Remote as shown in **Illustration 4**.

5. Match arrows then turn cover clockwise (**Illustration 5**).

IMPORTANT NOTES:

- Please use only new alkaline or lithium D-Cell batteries with 1.5V rating.
- Do not mix old and new batteries.
- Install batteries with polarity in correct position as shown.
- **Do not mount remote on metal** as it interferes with signal
- You must hold down button on remote for one second to control light
- **Spotlight only goes on in complete darkness! Test in a dark room or drawer.**

Distributed by:



www.PegasusLighting.com

800.392.4818

MOUNTING YOUR SPOTLIGHT TO SURFACE / WALL

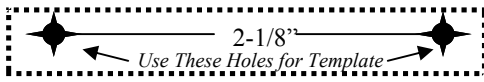

Illustration 6



Determine location for mounting Spotlight.
NOTE: FOR BEST PERFORMANCE, SPOTLIGHT SHOULD BE POSITIONED SO MOTION SENSOR IS ON TOP AND LIGHT IS ON BOTTOM. Use template (above) to mark two holes for anchors and/or screws (included) as shown in **Illustration 6**. NOTE: Spotlight can be rotated 360°, so screws can be mounted in any position. We recommend mounting the screws parallel to the ground if mounting on a vertical surface. Make sure that screws are precise distance from each other as configured in template (2-1/8" apart).

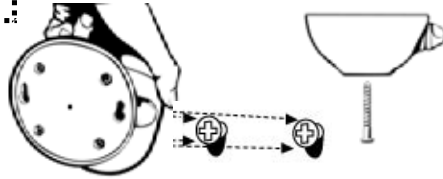

Illustration 7

Attach Mounting Base to screws as shown in **Illustration 7**. Slide Mounting Base down so screws are securely held by track. If using anchors, use 3/16" drill bit to drill holes and insert anchors. Drive screws into anchors so that screw head protrudes 1/8" from surface (the height of the screw head). If using screws only, use 1/8" drill bit to drill holes and insert screws so that screw head protrudes 1/8" from surface (the height of the screw head). Drive large screw through center hole as shown in **Illustration 8**.

Illustration 8



Illustration 9



Illustration 10



Illustration 11

To attach Spotlight to Mounting Base, align holes then insert and tighten thumb screw (**Illustration 9**). To adjust Spotlight direction, loosen smaller thumbscrew on Mounting Base and rotate Spotlight to proper direction as shown in **Illustration 10**. Tighten thumbscrew. Loosen larger thumbscrew that connects Spotlight Head to Mounting Base and adjust Spotlight Head to proper direction as shown in **Illustration 11**. Tighten thumbscrew.

MOUNTING YOUR SPOTLIGHT TO THE STAKE

Illustration 12



Loosen larger thumbscrew that connects Spotlight to Mounting Base and remove Mounting Base (**Illustration 12**).

Illustration 13



Insert stem into Stake as shown in **Illustration 13**

Illustration 14

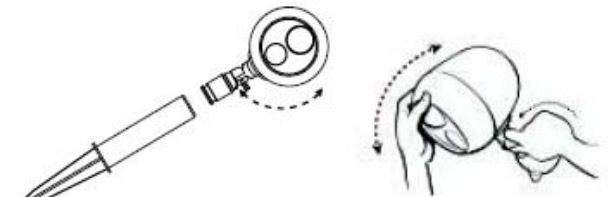

Loosen smaller thumbscrew to attain desired angle (**Illustration 14**). Tighten thumbscrew.

MOUNTING YOUR REMOTE CONTROL

Illustration 15

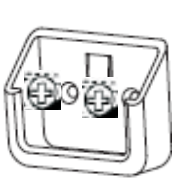

Screws

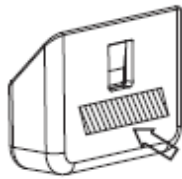

Tape Placement

Determine placement for bracket and attach to wall using two screws (enclosed) or tape as shown in **Illustration 15**.

Illustration 16

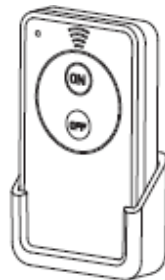

Slide Remote into Bracket as Shown in **Illustration 16**

Note: Hold down On and Off buttons for **one second** to control light.

LIMITED WARRANTY

The product you have purchased is guaranteed against defects in workmanship and materials for the period stated on the package. Warranties implied by law are subject to the same time period limitation. Some states do not allow limitations on how long an implied warranty lasts, so this time limitation may not apply to you. If the product fails due to a manufacturing defect during normal use, return the product and dated sales receipt to the store where purchased for replacement OR send the product and the dated sales receipt to the address above. **Not Covered** – Batteries are not covered by this warranty. Repair service, adjustment and calibration due to misuse, abuse or negligence are not covered by this warranty. Unauthorized service or modification to this product or of any furnished components will void this warranty in its entirety. This warranty does not include reimbursement for inconvenience, installation, set-up time, loss of use, postage, unauthorized service, or other products used in conjunction with, but are not supplied by, Wireless Environment. **This warranty gives you specific legal rights, and you may also have other rights which vary from state to state.**